

DRAWING MAY BE USED IN WHOLE OR PART, PROVIDED THE (IFFCO) NAME AND LOGO ARE VISIBLE IN ANY REPRODUCTION.

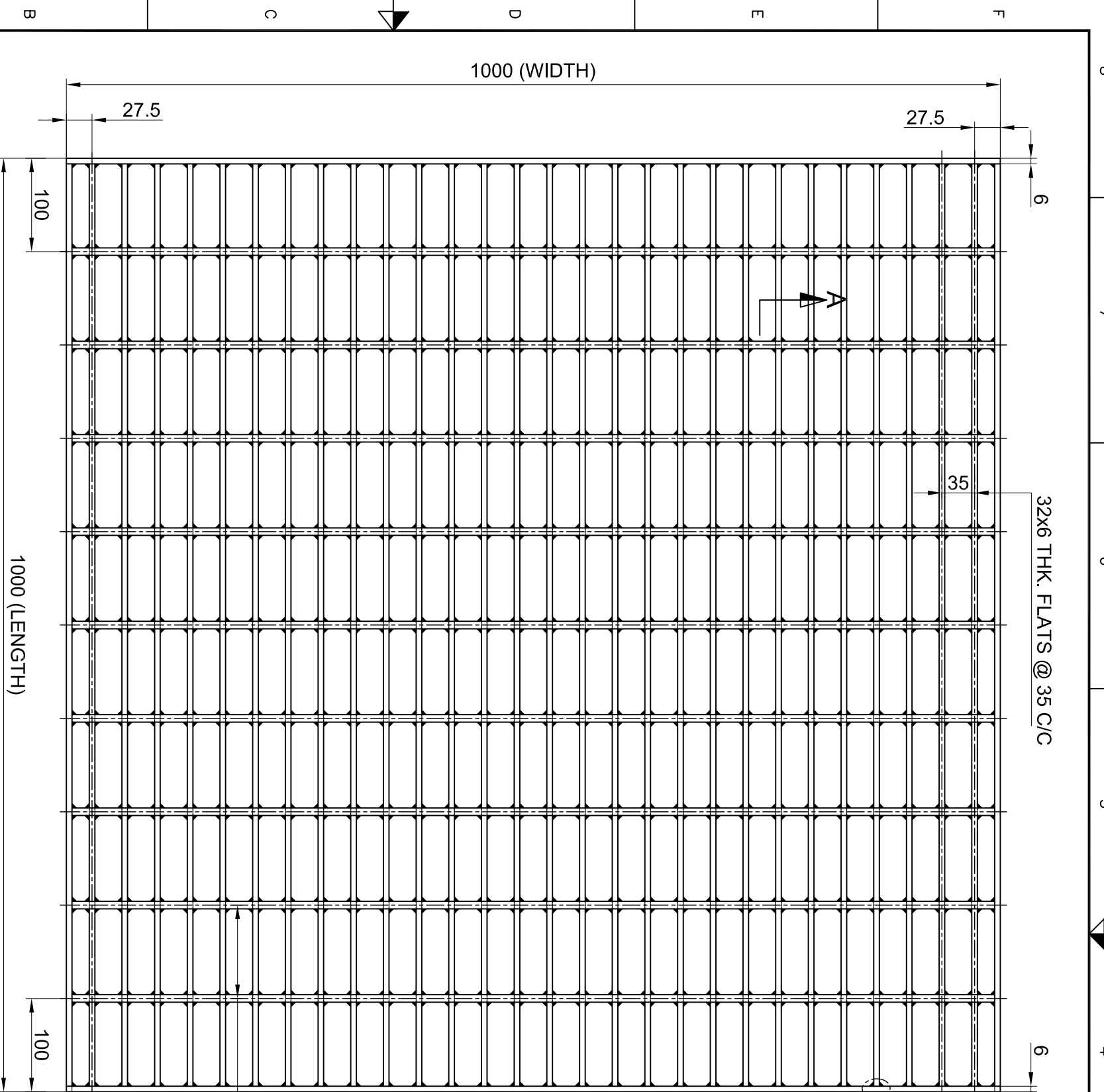

32x6 THK. FLATS @ 35 C/C

SCALE-1:5

DIMENSION TABLE

LENGTH	WIDTH	WT. IN Kgs. (APX.)
1000	1000	53.46

**NOTE:-**

- 1) ALL DIMENSIONS IN MM.
- 2) GRATING SIZE - 1000 MM (LENGTH) x 1000 MM (WIDTH)

8 MM SQ. TWISTED BAR @100 C/C

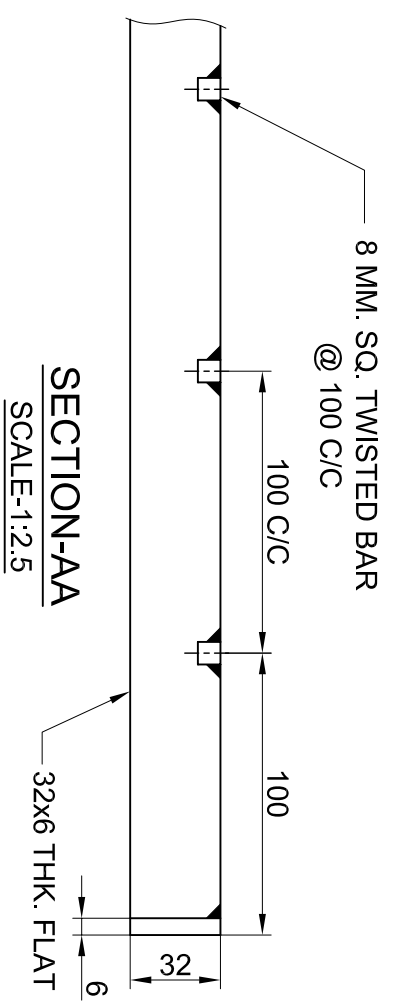

**SECTION-AA**  
SCALE-1:2.5

**DETAIL-X**  
SCALE-1:2

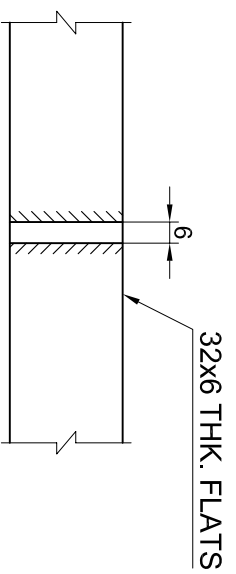

**MATERIAL:-** MILD STEEL FABRICATION FOLLOWED BY HOT DEEP GALVANIZED WITH GALVANIZATION THICKNESS OF MINIMUM-100 MICRONS.



**INDIAN FARMERS FERTILISER CO-OP.LTD.**  
PARADEEP - ORISSA - INDIA.

NAME	DATE	PLANT : U&O (PLANNING)	EWR No.
DRN S.S.WAIN	27.04.16		
CHD R.K.BARIK	02.05.16		
APD D.K.NEMA	02.05.16		

SCALE - AS SHOWN

**GRATING DETAILS (LIGHT DUTY)**  
SIZE-1000X1000

CODE	DRAWING NO.	PLANT	FORM	NUMBER	SHEET OF	REV.
06DB12208		06	D B	1 2 2 0 8	1 OF 4	1